

R:\Drawing Office\AutoCAD Files\Borough Green-B24r93 (Plan to Accompany Aftercare Management Plan).dwg

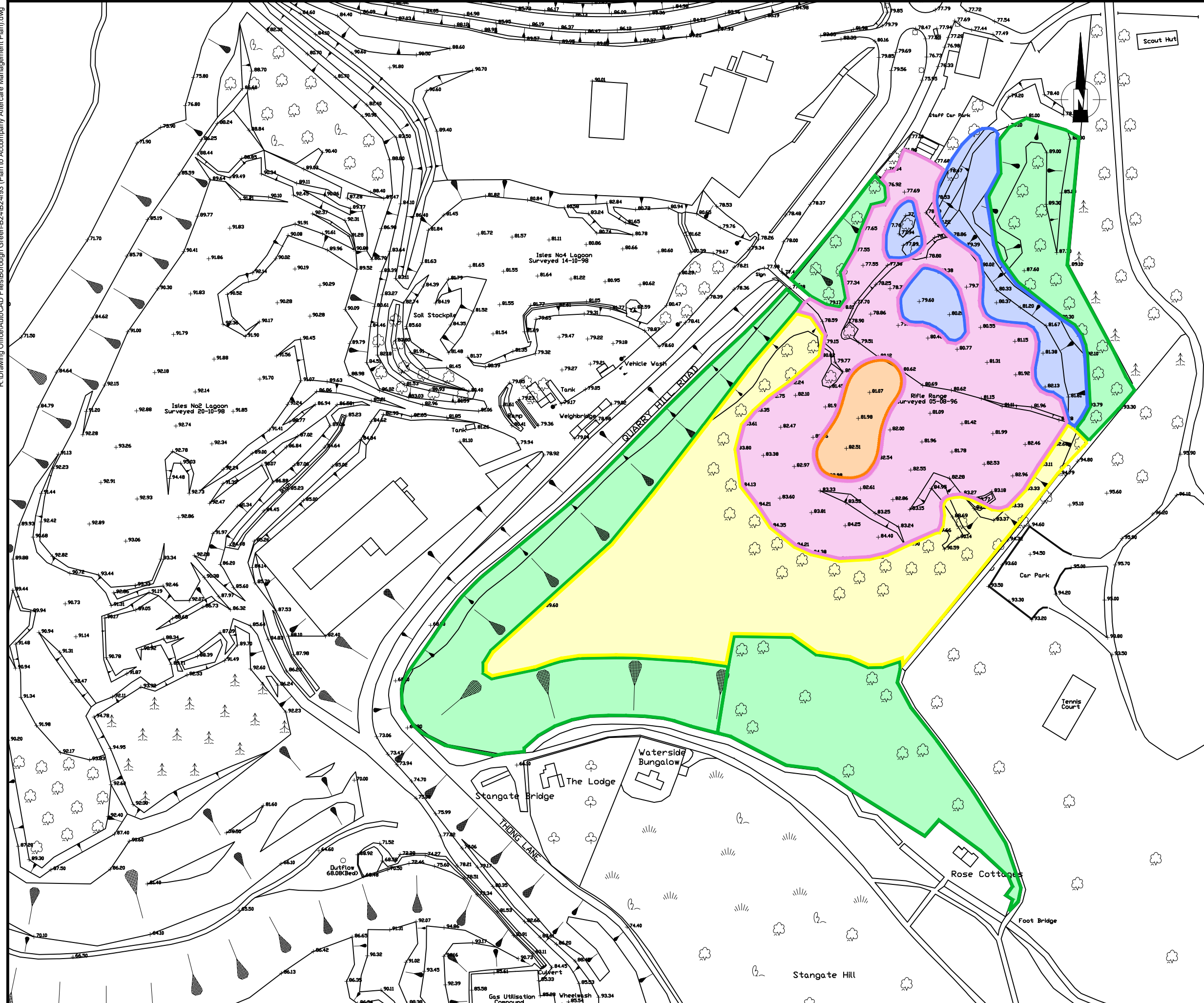

KEY

- Short wildflower grassland (1.81ha)
- Tall rough grassland (0.18Ha)
- Pole stage regeneration (1.88Ha)
- Young regeneration (0.49Ha)
- Established semi-natural woodland (2.77Ha)

Received 23 December 2014
Planning Applications Group



Site Borough Green		
Title Plan to Accompany Aftercare Management Plan		
Scale 1:2,000 @ A3	Date Dec '14	Drawing No. B24r/93
Drawn by JWB	Checked by JM	